

## 230V Gearmotor



Max. leaf weight

900 Kg

Max speed

12 m/min.

Use frequency

40%

- Easy programming thanks to the display and to the prewired control unit
- Magnetic limit switch.
- Integrated encoder with reverse function upon obstacle detection and specific management in opening and slow down



## DIMENSIONS AND TECHNICAL SPECIFICATIONS

Model	741 E Z16 with encoder
Power supply voltage	220-240V~ 50/60 Hz
Electric motor	Asynchronous single phase
Max. power	500 W
Max. torque	24 Nm (*)
Max expressed force	650 N (*)
Reduction ratio	1:25
Max. leaf width	15 m
Leaf speed	12 m/min
Speed adjustment and motor control	No
Limit switch	Magnetic
Pinion	Z16 module 4
Encoder	Optical encoder
Force adjustment	Via electronic control board
Operating ambient temperature	-20°C ÷ +55°C
Thermal protection	140°C
Protection class	IP44
Weight	11 Kg
Dimensions (LxDxH)	295 x 181 x 320 mm
Max. leaf weight	900 Kg
Use frequency	S3 - 40%
Electronic equipment	740D incorporated

(\*) data referred to 230V~ 50Hz.

## FAMILY MODELS

Model	Item code
741 E Z16 with encoder	1097815

## PACKS

**741 includes:** an electromechanical gearmotor with 740D control unit, encoder for anti-crushing safety device, pinion for rack, two release keys, foundation plate, limit switch magnets.

Typical Installation Examples page. 328

## ELECTRONIC CONTROL UNITS



740D (incorporated in automation)  
Info at page 140

202269

## RACKS



Galvanised rack 30x12 mod. 4 including weld-on fittings (4 pcs pack, 1 m each)

490122



Galvanised rack 30x8 mod. 4 including weld-on fittings (4 pcs pack, 1 m each)

490123



Galvanised rack 30x12 mod. 4 including mechanical fittings (4 pcs pack, 1 m each)

490124

>>



Galvanised rack 30x8 mod. 4 including mechanical fittings (4 pcs pack, 1 m each)

490125



30x20 mod.4 nylon rack with steel core (4 pcs pack, 1 m each)♦

490333



Kit of 4 fastening screws to be screwed in (package of 4 kits) to be combined with 1 m of 490333  
390178

## INSTALLATION DIMENSIONS (MM)

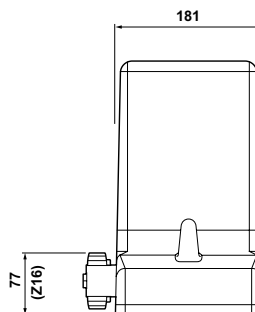
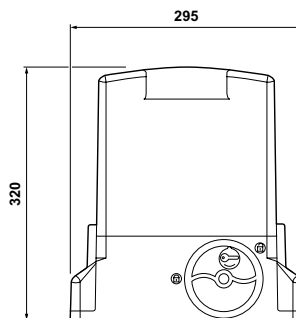

For any other configuration please refer to the technical manual

## NOTE

♦ Max gate weight: 400kg.

### OTHER ACCESSORIES

Key operated buttons  
page 174

Safety edges  
page 185

Transmitters and receivers  
page 166

Photocells and columns  
page 182

Flashing lights  
page 191

Various accessories  
page 192