



# PRODUCT CATALOGUE

2021

---

GATES AUTOMATION  
AND BARRIERS

---

ACCESS CONTROL  
SYSTEMS

---

ENTRANCES &  
AUTOMATIC DOORS

---

MOTORS FOR SHUTTERS  
AND AWNINGS

**FAAC**  
*Simply automatic.*



# C4000I

## Integrated gearmotor 24V



**NEW**

**Max. leaf weight**

**400 Kg**

**Max speed**

**16 m/min**

**Type of use**

**Residential**



- Compact dimensions, perfectly integrable in the architectural context
- Electronic control unit and absolute electronic encoder (patented), having functions of reverse on obstacle and recognition of limit switches
- Manual unlocking accessible from inside and outside the property



### DIMENSIONS AND TECHNICAL SPECIFICATIONS

Model	C4000I
Power supply voltage	220-240V ~ 50/60 Hz
Electric motor	24 V
Max. power	150 W
Max expressed force	125 N
Pinion	Z16 module 4
Max. leaf width	8 m
Max. leaf weight	400 kg
Max cantilever leaf weight	250 kg
Leaf speed	16 m/min
Operating ambient temperature	-20 °C +55 °C
Type of use	Residential
Continuous use time (ROT)	Continuous
Protection class	IP30
Dimensions (LxDxH)	110 x 180 x 250 mm
Weight	3,5 kg
Column dimensions	110x110 mm minimum internal dimension

## FAMILY MODELS

Model	Item code
C4000I	109001

## PACKS

**C4000I includes:** an electromechanical actuator in low voltage with electronic equipment E4000I pinion gear for rack, a release key and fastening accessories

## ELECTRONIC CONTROL UNITS

E4000I electronic board incorporated in automation

## ACCESSORIES



Galvanised rack 30x12 mod. 4 including weld-on fittings (4 pcs pack, 1 m each)

490122



Galvanised rack 30x8 mod. 4 including weld-on fittings (4 pcs pack, 1 m each)

490123



Galvanised rack 30x12 mod. 4 including mechanical fittings (4 pcs pack, 1 m each)

490124

>>



Galvanised rack 30x08 mod. 4 including mechanical fittings (4 pcs pack, 1 m each)

490125



30x20 mod.4 nylon rack with steel core (4 pcs pack, 1 m each) ♦

490333



Kit of 4 fastening screws to be screwed in (package of 4 kits) to be combined with 1 m of 490333

390178

## INSTALLATION DIMENSIONS (MM)

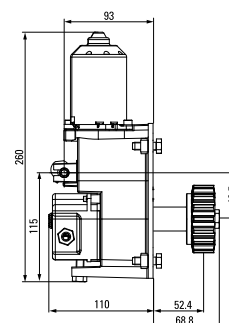
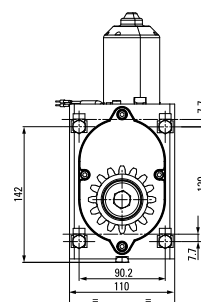

## NOTE

♦ Max gate weight: 400kg.

For any other configuration please refer to the technical manual

## OTHER ACCESSORIES

Key operated buttons  
page 176

Safety edges  
page 187

Transmitters and receivers  
page 168

Photocells and columns  
page 184

Flashing lights  
page 194

Various accessories  
page 195